

Simple easy DG-505 Manual

Model No:FF-B042/FF-B043

Scale Glider Radio control airplane Wingspan:4000mm



Basic parts

1	Carbon Rod 12*525mm for main wing joinner	10	M4*20 Butterfly Screws for lock the wings
2	Carbon Rod 10*330mm *2pcs for second wing joinner	11	FF12-05 Linkage Stoppers*10/set
3	Plastic Servo tray *5pcs	12	M3*10 Screws*4pcs for locking motor
4	Carbon pin 6*50mm 6pcs for stable wings	13	Metal Collar*2/set
5	Push Rod M1.5*65 *5pcs for Flap,rudder and	14	2*8mm Screws 35 pcs
6	004-00140 Hinges*3	15	Metal Clevis M1.5 *3pcs
7	Soft wire*2pcs for elevator	16	M4*35 Screws*2/pcs for locking the stable tail
8	LL04-405B Horns 8pcs for push all the servos	17	2*25mm 6pcs Pin for Wingtips
9	Metal Pinned Hinges*4pcs for canopy	18	FF1-130 Optional Alum retract with servo tray*1/set

Warning !

- First-time fliers should seek advice on pre-flight adjustments and assembly from experienced fliers. Remember that flying a badly assembled or badly adjusted aircraft is very dangerous!
- In The beginning, novice fliers should always be assisted by an experienced flier and should never fly alone!
- This model aircraft is designed to be powered by an electric-motor. Installing a over power motor and engine, or flying this model aggressively may lead to serious damage and accidents!

UNDER SAFETY PRECAUTIONS

This radio controlled plane is not a toy!

Always keep this instruction manual ready on hand for quick reference.

Assemble this kit only places out of children reach.

First-time builders of RC radio power model should seek the advice of experienced modellers before beginning assembly and if they do not fully understand any parts of the construction.

Taking out liability insurance is recommended.

You are responsible for this model's assembly and safe operation.

Epoxy Glue

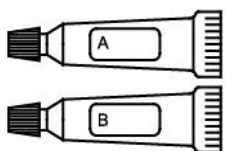

Scissors

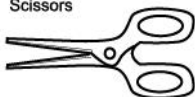

Screw driver

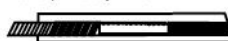
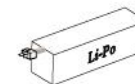
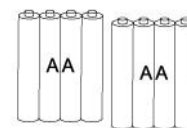

Sharp Hobby Knife

**Battery required**Li-Po Batteries
(Motor)A-A-size Batteries
(Transmitter)

Needle Nose Pliers

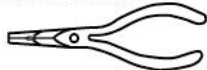

Awl



Double-sided Tape



Solder

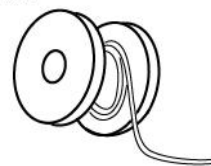

8mm Box Driver



Solder Iron (80W above)



The pre-covered film on ARF kits may wrinkle due to variations of temperature. Smooth out as explained below.

Use an iron covered with a cloth! Start at low setting. Increase the setting if necessary. If it is too high, you may damage the film.

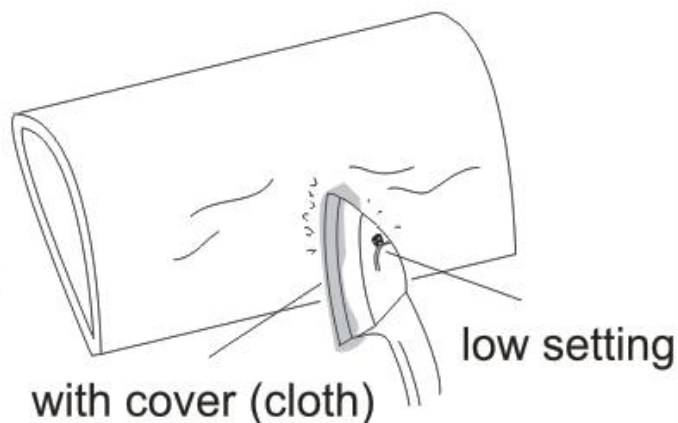
**You need to purchase the following accessories power system separately to complete the model.**

FF3-309B Motor 720kv 1pcs	FF14-03 Servo extension cable: 800mm 8pcs
FF4-402 ESC 60A 1pcs	FF14-06 Y# extension cable: 300mm *2pcs
FF10-107 Alum Propeller & spinner 11*7 φ38mm /1set	Battery 5S 35C 3500-4000mAh 1pcs for electric
FF9-912 MG Servo 17g 7pcs	

(1). Installing The wings: need to preparing: 17g Servos*4pcs (Flyfly item no:FF9-911) Servos extension cables 800mm*6pcs (Flyfly item no:FF14-03)
Parts: Horns(No:LL04-406A/B), Servo tray, Push rods(No:NN17-00401), Linkage Stoppers(No:FF12-05)

**Push Rod Fixed to the servo horns**

Put the servo in to the servo tray, with 2 screws locked

**locked with 4 screws****Push rod & Linkage Stoppers**

After finished like this photo, Adjust the aileron & Flaps, then locked the Linkage stoppers, please remember the servo horns between the Linkage

(2). Installing elevator & Tail Rudder: need to preparing 17g metal servos*2 pcs (FF item no:FF9-912)

Servos extension cables 800mm*2pcs (Flyfly item no:FF14-03)

Parts:Horns(FF item no:LL04-406A/B),Soft wire, Metal collar, servo tray, push rod

Linkage Stoppers(FF item no: FF12-05)

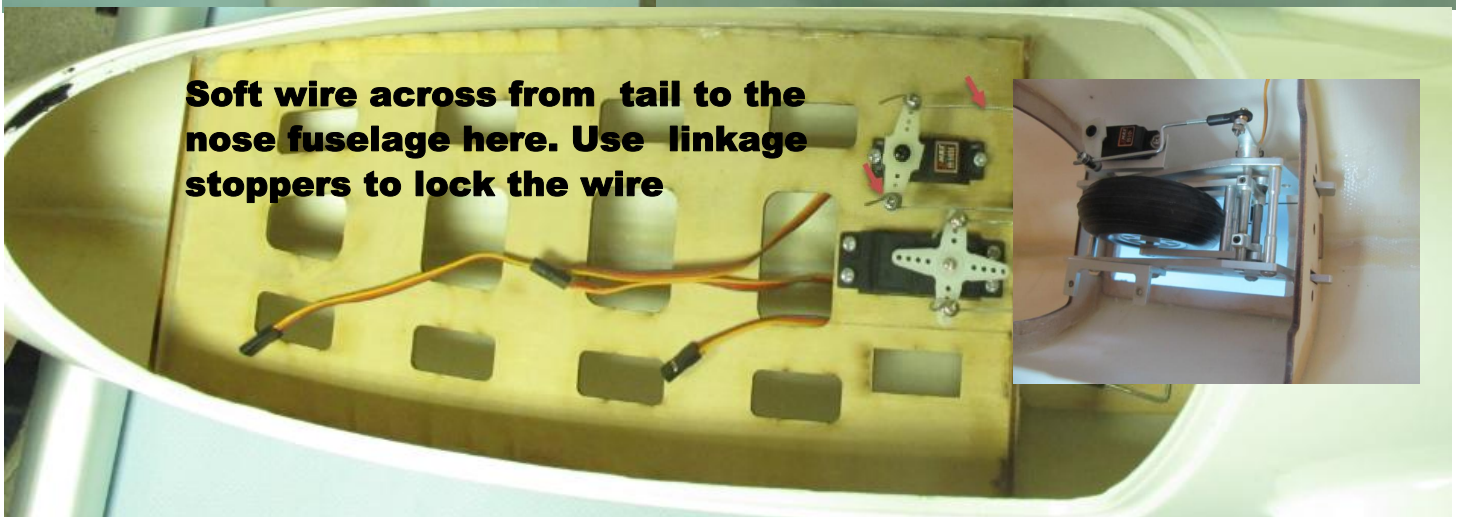
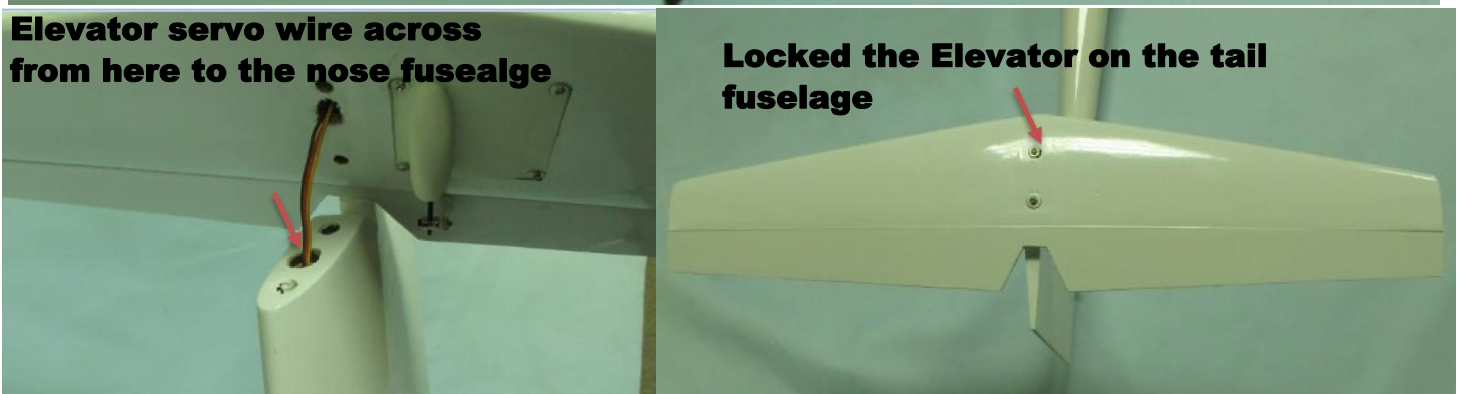
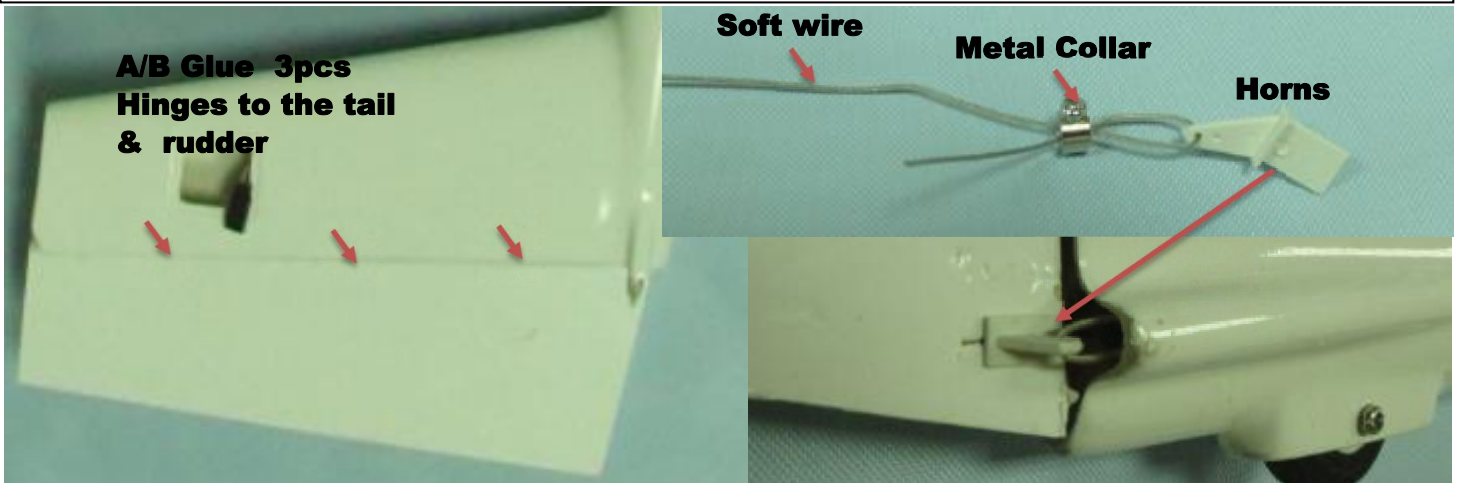

(3). Landing gear installing: : need to fit a 17g metal servos*1 pcs (FF item no:FF9-912)

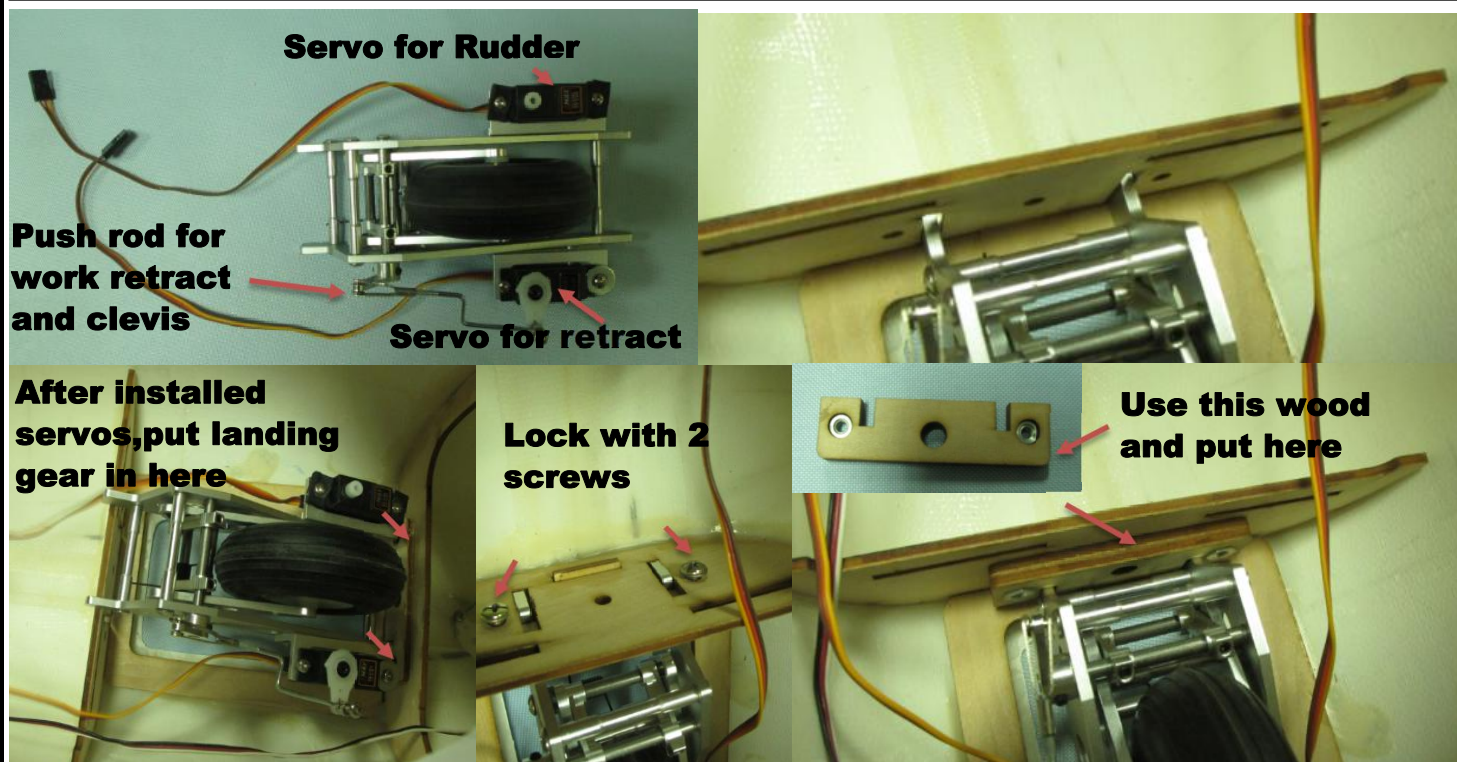

(4). Canopy installing

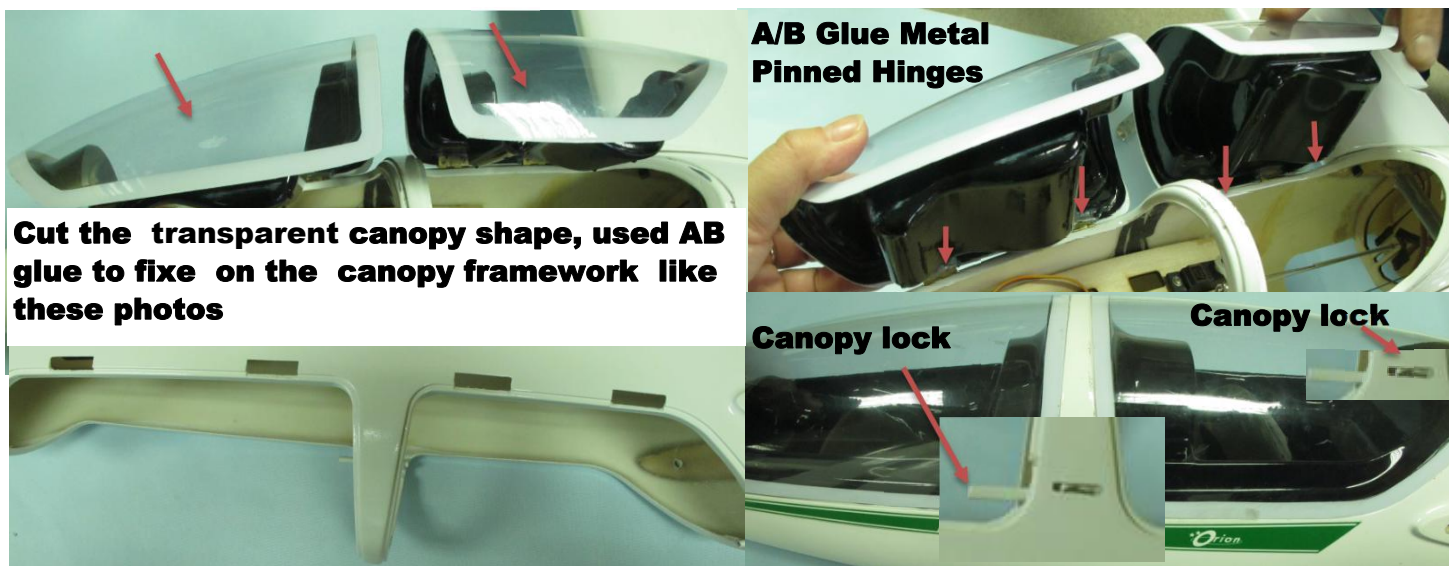

(5). Joined wings and Decals

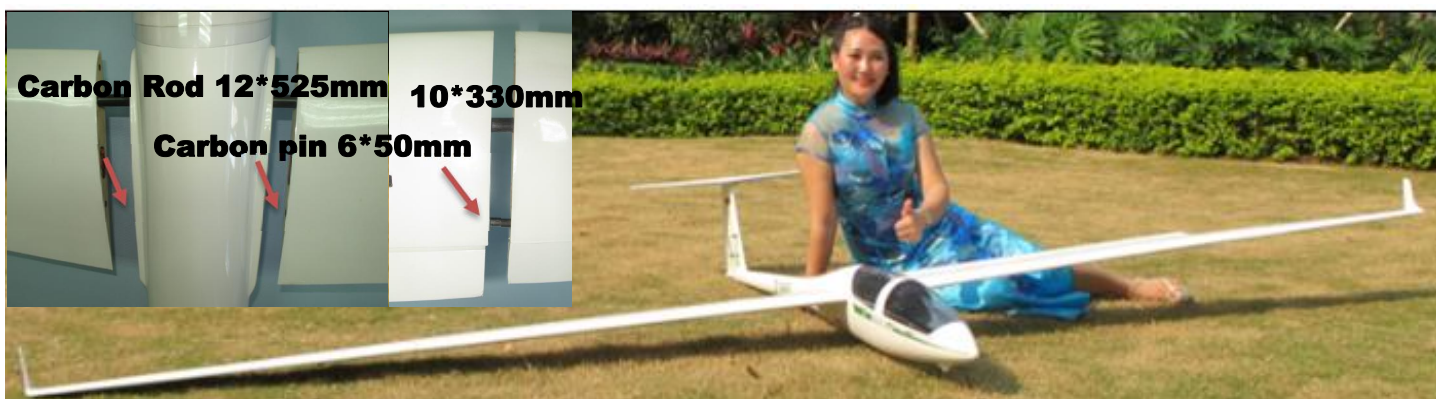

-

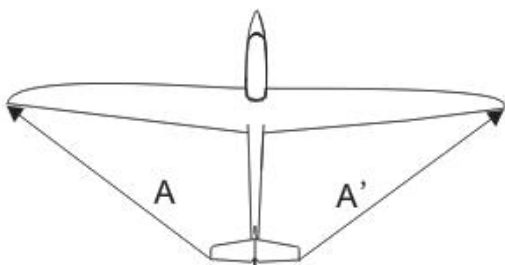
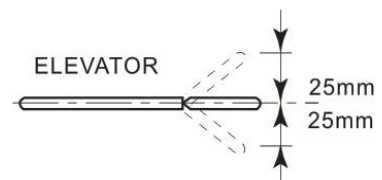
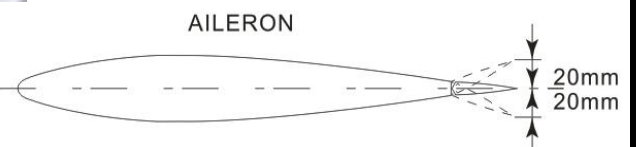
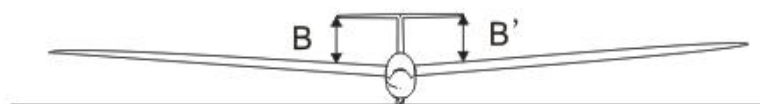
$$\begin{aligned} A &= A' \\ B &= B' \end{aligned}$$

The CG position will vary depends on you requirement. adjust the CG to achieve your control style.

